



## Selector housing

🔑 44.15.04

### Remove

1. Raise front of vehicle.

**WARNING:** Do not work on or under a vehicle supported only by a jack. Always support the vehicle on safety stands.

2. Remove front console.

👉 **INTERIOR TRIM COMPONENTS, REPAIRS, Console - front - up to 04MY.**

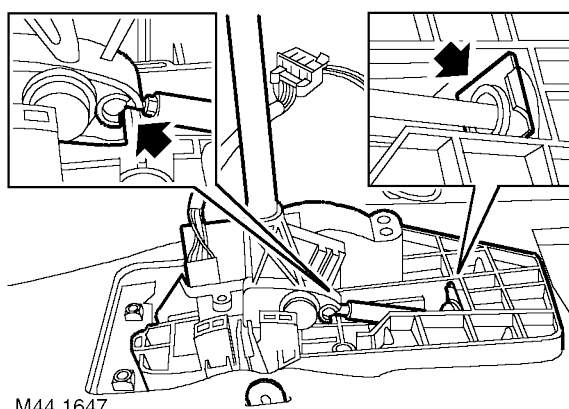

M44 1647

3. Release inner cable from selector lever.
4. Remove 'C' clip securing outer cable to selector housing.
5. If fitted, release mirror fold ECU and place aside.

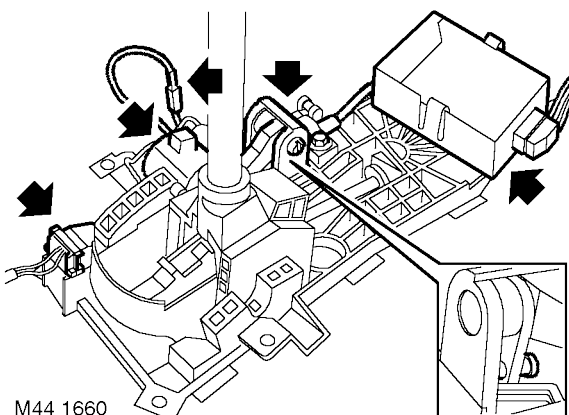

M44 1660

6. Disconnect shift interlock solenoid connector.
7. Disconnect multiplug from sport/manual switch.
8. If fitted, remove bolt and disconnect cable from key interlock mechanism.

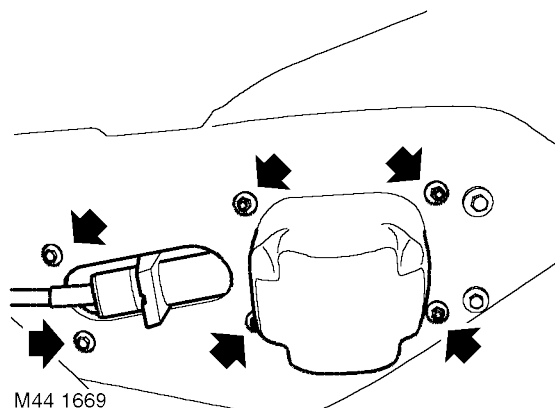

M44 1669

9. Remove 6 nuts securing selector housing.
10. Remove selector housing.
11. Remove screw and remove mirror fold ECU housing.

### Refit

1. Position mirror fold ECU housing and secure with screw.
2. Fit selector housing, fit nuts and tighten to 10 Nm (7.5 lbf.ft).
3. Connect key interlock mechanism inner cable. Locate outer cable, fit clamp and clamp bolt but do not tighten clamp bolt at this stage.
4. Connect multiplug to sport/manual switch.
5. Connect shift interlock solenoid connector.
6. Secure inner cable to selector lever.
7. Secure outer cable to selector housing with 'C' clip.
8. Check key interlock cable adjustment.  
👉 **STEERING, ADJUSTMENTS, Cable - key interlock - adjust.**
9. Fit front console.  
👉 **INTERIOR TRIM COMPONENTS, REPAIRS, Console - front - up to 04MY.**
10. Remove stand(s) and lower vehicle.

---

### Gear knob

---

🔑 44.15.07

#### Remove

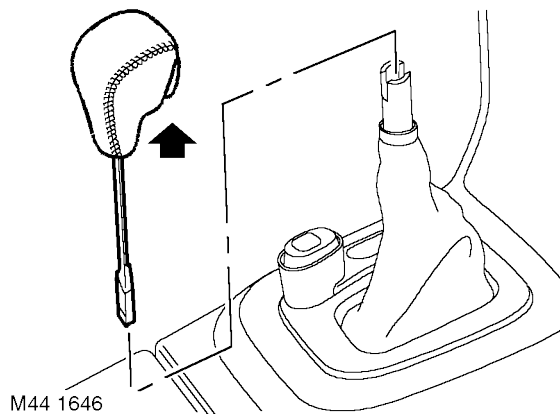

*Pre 04MY illustrated, (04MY onward similar)*

1. Pull gear knob upwards to disengage locating tang from gear selector lever.

**WARNING:** *Gear knob will be released suddenly, keep face clear of gear knob during removal.*

#### Refit

1. Position gear knob to gear selector lever engaging locating tang on knob with slot in selector lever.
2. Push gear knob fully on to gear selector lever.

**CAUTION:** *Selector lever must be in 'Park' before fitting knob, failure to comply may result in damage to selector assembly.*



## Selector cable

🔑 44.15.08

### Remove

1. Remove front console.  
👉 **INTERIOR TRIM COMPONENTS, REPAIRS, Console - front - up to 04MY.**

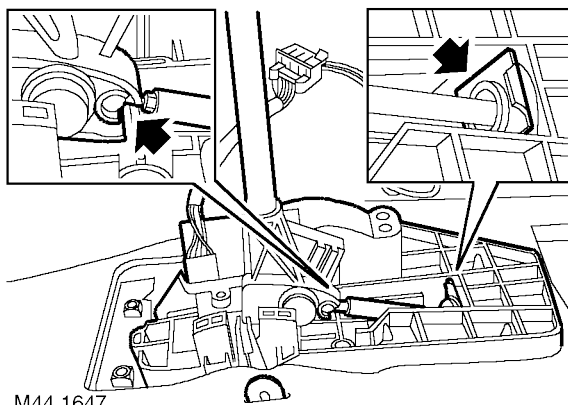

M44 1647

2. Release inner cable from selector lever.
3. Remove 'C' clip securing outer cable to selector housing.
4. Raise front of vehicle.

**WARNING: Do not work on or under a vehicle supported only by a jack. Always support the vehicle on safety stands.**

5. Remove underbelly panel.  
👉 **EXTERIOR FITTINGS, REPAIRS, Panel - underbelly.**
6. Remove cable tie and release gear selector cable from clip on body.

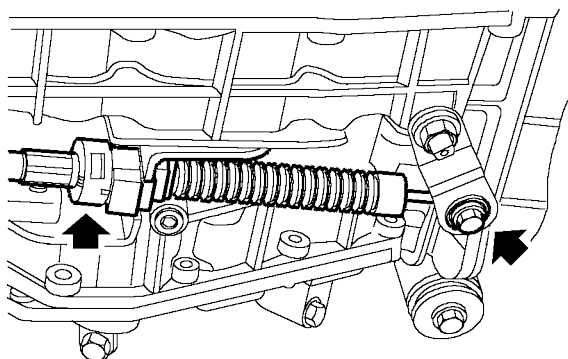

M44 1648

7. Loosen selector cable trunnion nut.
8. Release clip securing selector cable to gearbox bracket, remove selector cable and collect trunnion from selector lever.

### Refit

1. Position trunnion to selector lever, locate inner cable through trunnion, do not tighten nut at this stage.
2. Position selector cable to gearbox bracket and secure with clip.
3. Locate cable in selector housing and secure outer cable in clip.
4. Secure outer cable to selector housing with 'C' clip.
5. Secure inner cable to selector lever.
6. Fit front console.  
👉 **INTERIOR TRIM COMPONENTS, REPAIRS, Console - front - up to 04MY.**
7. Check and adjust selector cable.  
👉 **AUTOMATIC GEARBOX - JATCO, ADJUSTMENTS, Selector cable - adjust.**
8. Fit underbelly panel.  
👉 **EXTERIOR FITTINGS, REPAIRS, Panel - underbelly.**
9. Remove stands and lower vehicle.

---

### Selector indicator - up to 03 MY

---

🔑 44.15.10

#### Remove

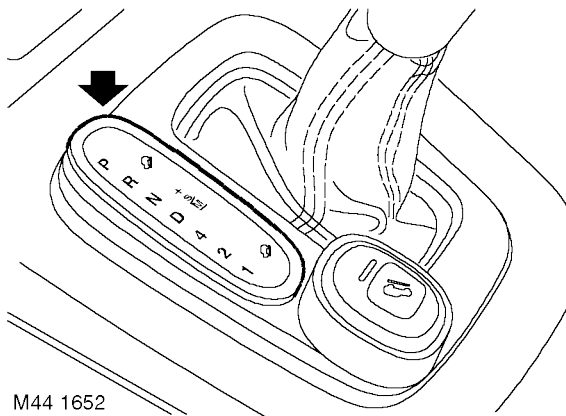

1. Release selector indicator from selector lever trim panel.

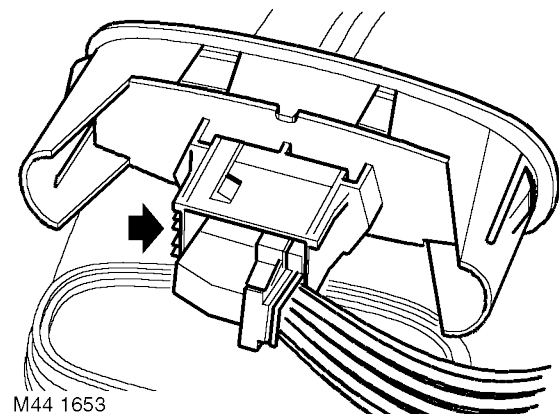

2. Disconnect multiplug from selector indicator and remove indicator.

#### Refit

1. Connect multiplug to selector indicator.
2. Position selector indicator to selector lever trim panel.



## Selector indicator - from 04MY

44.15.10

### Remove

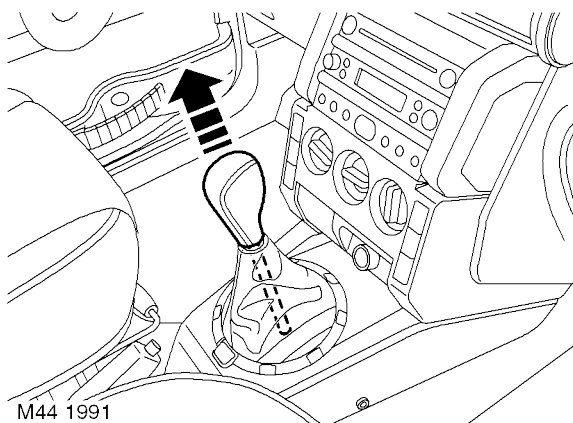

1. Position gear selector lever in 'Neutral' and remove gear selector knob.

**WARNING:** Gear knob will be released suddenly, keep face clear of gear knob during removal.

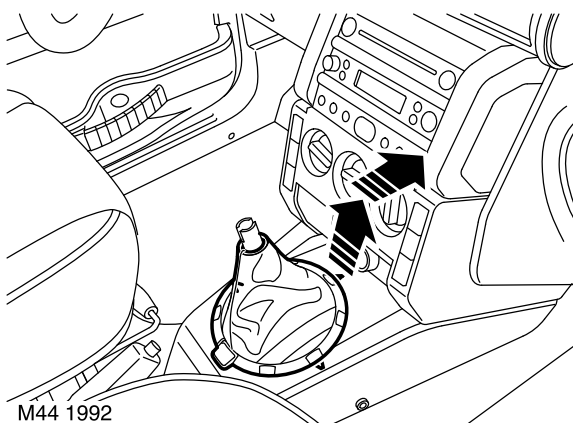

2. Working from forward edge, carefully release spring clip securing gear selector indicator assembly to centre console. Release 2 additional clips at the sides and slide assembly forward.

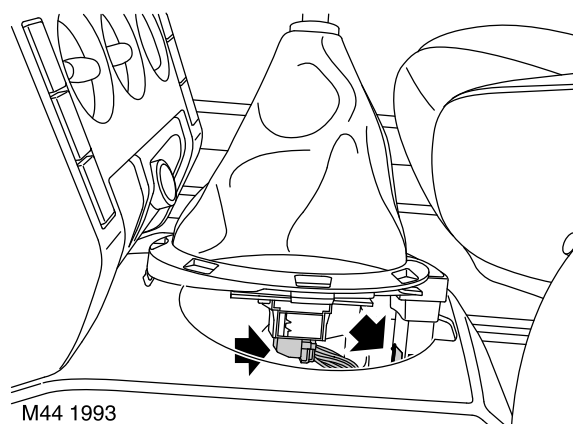

3. Disconnect multiplug from hill descent switch.
4. Disconnect multiplug from gear selector indicator module.
5. Remove gear selector indicator assembly.

### Refit

1. Position gear selector indicator assembly to centre console.
2. Connect 2 multiplugs.
3. Ensure LED display module is located on pegs.
4. Fit and secure gear selector indicator assembly to centre console.
5. Fit gear selector knob.

**CAUTION:** Selector lever must be in 'Park' before fitting knob, failure to comply may result in damage to selector assembly.

## AUTOMATIC GEARBOX - JATCO

### Inhibitor switch

🔑 44.15.19

#### Remove

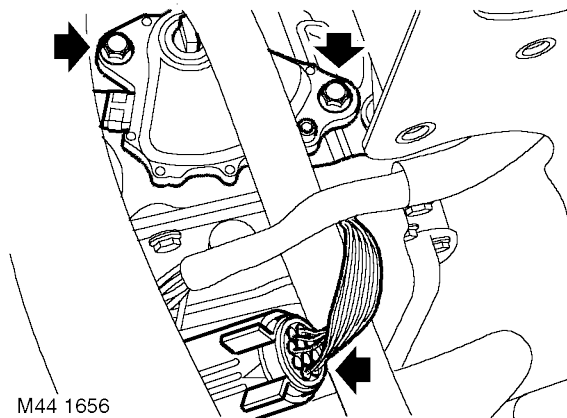

1. Release inhibitor switch harness multiplug from clip on fluid pan and disconnect multiplug.
2. Set selector lever to 'N' position.
3. Remove 2 bolts securing inhibitor switch to gearbox and remove inhibitor switch.

#### Refit

1. Clean inhibitor switch and mating face on gearbox.
2. Align the internal lugs with the mark on the inhibitor switch.
3. Position inhibitor switch, aligning the 2 lugs with the machined grooves in the selector lever shaft.
4. Fit bolts securing inhibitor switch but do not tighten at this stage.
5. Connect inhibitor switch multiplug and secure to mounting bracket with clip.
6. Adjust inhibitor switch.

👉 **AUTOMATIC GEARBOX - JATCO,**  
**ADJUSTMENTS, Inhibitor switch - adjust.**

### ECU

🔑 44.15.46

#### Remove

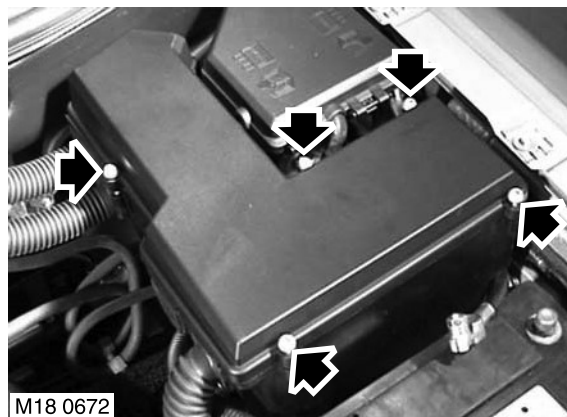

1. Loosen 5 screws and remove 'E' - box lid.

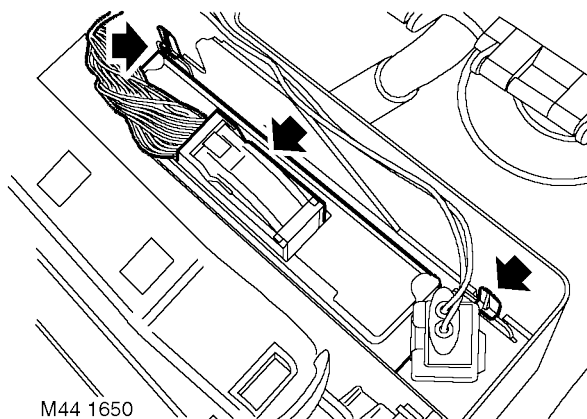

2. Release 2 retainers and withdraw ECU.
3. Disconnect multiplug from ECU and remove ECU.

#### Refit

1. Connect multiplug to ECU.
2. Locate and secure ECU.
3. Fit 'E' - box lid and tighten screws.