

Assembly

11. Remove bearing cups from new spider.
12. Check all needle rollers are present and positioned in bearing cups.
13. Ensure bearing cups are one-third full of lubricant **See LUBRICANTS, FLUIDS AND CAPACITIES, Information, Recommended lubricants and fluids**.
14. Enter new spider with seals into yokes of sliding member flange.
15. Partially insert one bearing cup into flange yoke and enter spider trunnion into bearing cup.
16. Insert opposite bearing cup into flange yoke.
17. Press both cups into place.

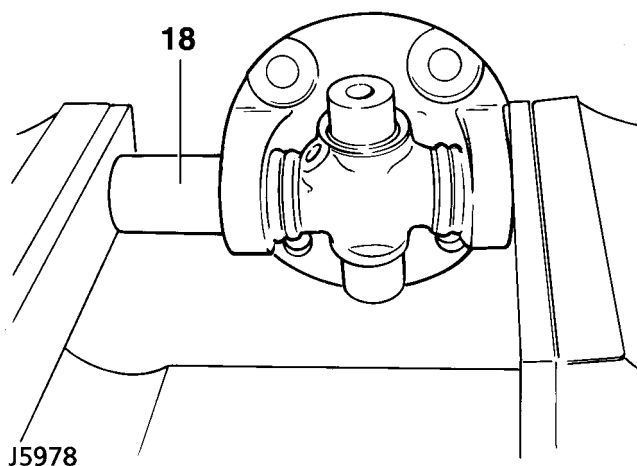

18. Press each cup into its respective yoke up to lower land of circlip grooves. Damage may be caused to cups and seals if cups pass this point.
19. Fit circlips and check no end float exists.

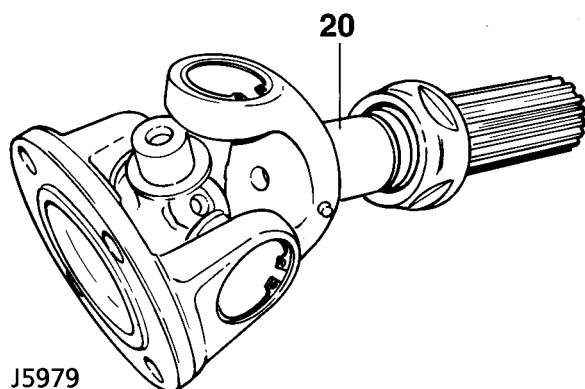

20. Engage spider in yokes of sliding member. Fit bearing cups and circlips as described in instructions 14 to 19.

21. Fit grease nipples to spider and sliding member.
22. Apply instructions 14 to 19 to opposite end of propeller shaft.
23. Fit grease nipple and lubricate.

Refit

24. Fit propeller shafts to vehicle with sliding joints to transfer box and tighten nuts to **47 Nm (35 lbf/ft)**.