

## Type LC

A flange clamp for parallel or tapered flanges with tapped holes to accept threaded rod or cable clips. Supplied with a high tensile cup point setscrew.

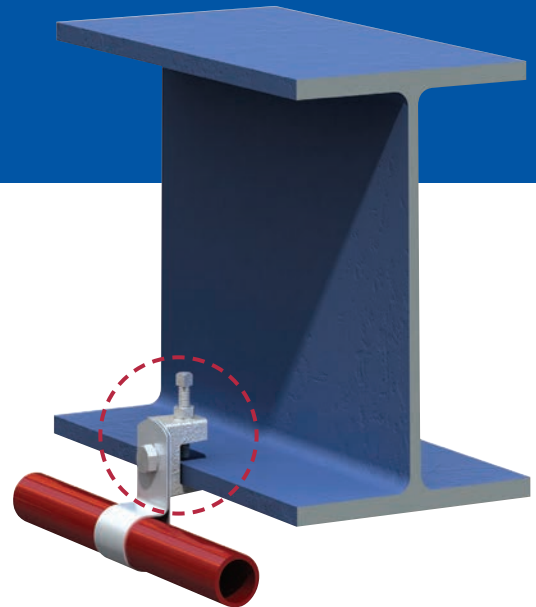
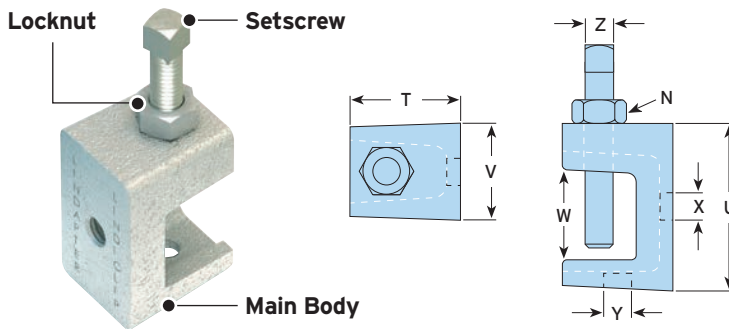

Material: Malleable iron, zinc plated.

➤ Installation is the same as Type FL (page 54).

| Product Code | Thread |    | Safe Working Load (FOS 4:1) |                          | Clamping Range W mm | Setscrew Z | Tightening Torque |              | Dimensions |      |            |
|--------------|--------|----|-----------------------------|--------------------------|---------------------|------------|-------------------|--------------|------------|------|------------|
|              | X      | Y  | Tensile in Position X kN    | Tensile in Position Y kN |                     |            | Setscrew Z Nm     | Locknut N Nm | T mm       | U mm | Width V mm |
| LC06         | M6     | M6 | 0.18                        | 0.59                     | 3 - 20              | M6         | 4                 | 4            | 25         | 36   | 21         |
| LC08         | M8     | M8 | 0.18                        | 0.59                     | 3 - 20              | M6         | 4                 | 4            | 25         | 36   | 21         |

## Type SW

A swivel unit for applications on inclined beams complete with a M10 x 90mm (property class 8.8) setscrew and nut. Can be supplied with Type FL or Type Z10.

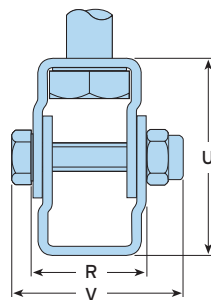
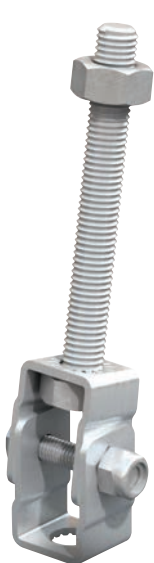

Material: High grade alloy steel, zinc plated.

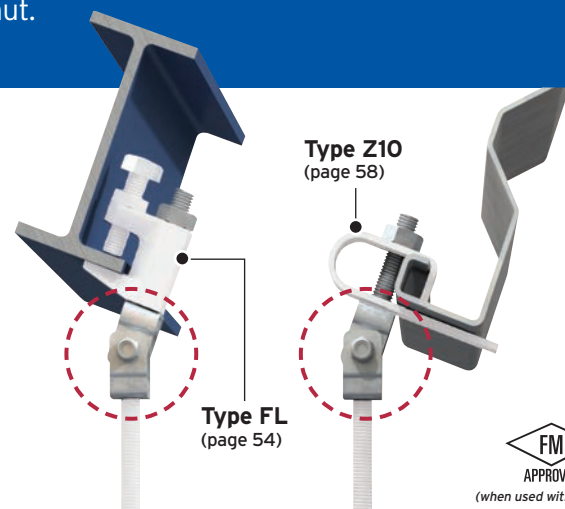

| Product Code | Rod | Safe Working Load (FOS 4:1) |  | Maximum Inclination | Rotation | Tightening Torque Nm | Dimensions |      |                      |
|--------------|-----|-----------------------------|--|---------------------|----------|----------------------|------------|------|----------------------|
|              |     | Tensile kN                  |  |                     |          |                      | U mm       | R mm | Width with Bolt V mm |
| SW10         | M10 | 2.4                         |  | 18°                 | 360°     | 11                   | 45         | 25   | 35                   |