



REAR HUB - 110/130

Service repair no - 64.15.14.

Overhaul

1. Remove rear hub assembly *See Repair, Rear hub assembly.*

2. Remove outer bearing.
3. Mark, for reassembly, relationship between hub and brake disc, if original hub is to be refitted.
4. Remove 5 bolts and separate hub from brake disc.
5. Drift out grease seal and inner bearing from hub and discard seal.

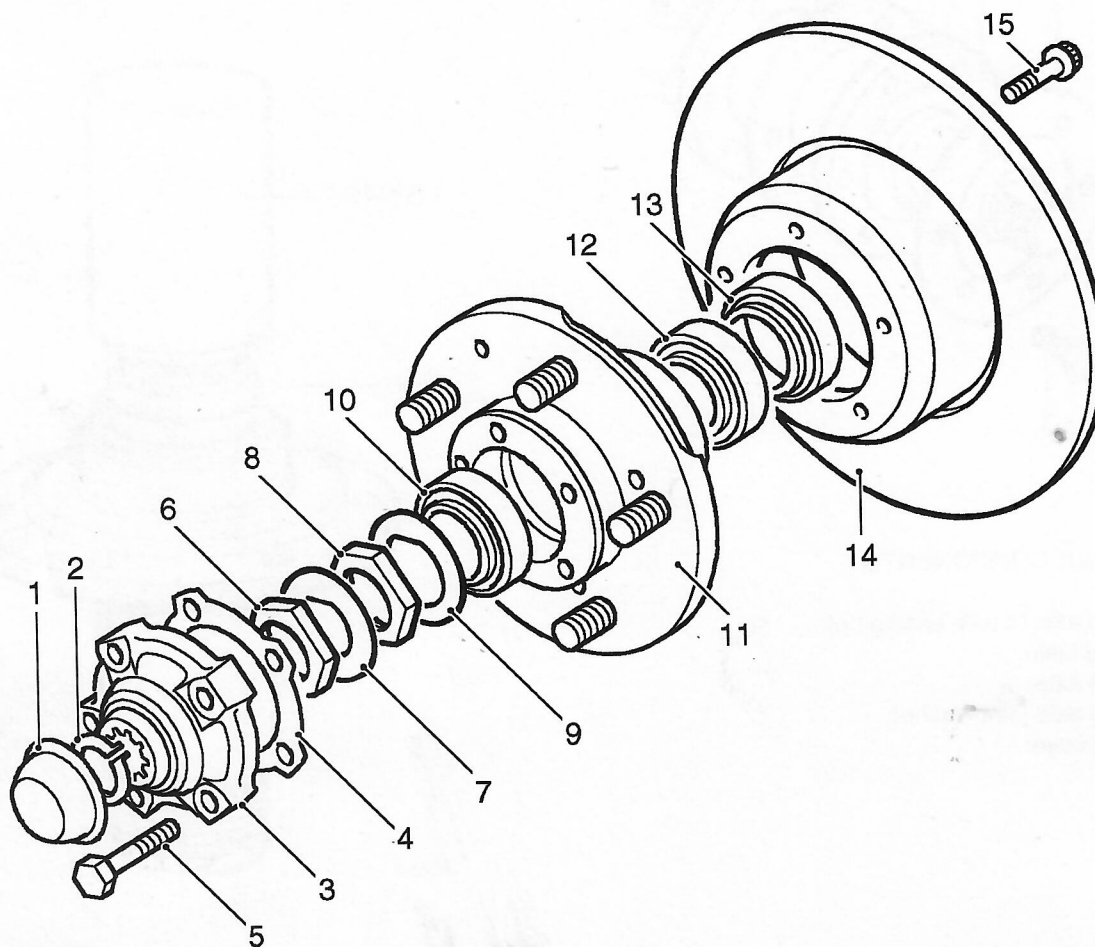

HUB COMPONENTS

- | | |
|---------------------------------|--------------------------|
| 1. Dust cap. | 9. Spacing washer. |
| 2. Drive shaft circlip. | 10. Outer bearing. |
| 3. Drive member. | 11. Hub. |
| 4. Drive member joint washer. | 12. Inner bearing. |
| 5. Drive member retaining bolt. | 13. Grease seal. |
| 6. Lock nut. | 14. Brake disc. |
| 7. Lock washer. | 15. Disc retaining bolt. |
| 8. Hub adjusting nut. | |