

Item	Part Number	Description
1	-	Air inlet duct
2	-	Air intake and blower assembly
3	-	Heater assembly and controls
4	-	air conditioning (A/C) thermostatic switch
5	-	Water valve and bracket assembly
6	-	A/C refrigerant pressure switch
7	-	A/C evaporator
8	-	A/C thermostatic expansion valve
9	-	A/C receiver drier
10	-	A/C condenser assembly
11	-	A/C compressor

## OVERVIEW

The climate control system features heating, and where fitted, A/C operations. Heating selections are made using the left-hand (LH) rotary control mounted on the center console. The rotary control is connected via a Bowden cable to a water valve in the engine cooling system. The water valve allows a varying amount of engine coolant to flow into the heater matrix. The amount of coolant entering the heater matrix determines the heat transferred to the inlet air and thus the amount of heat transferred into the cabin.

Blower motor speed is controlled using a 4 position sliding switch. The switch allows 3 blower motor speeds to be selected by controlling the ground path for the blower motor in conjunction with a resistor pack. The blower motor and resistor pack are both located in the engine compartment.

Air distribution into the cabin is selected using the right-hand (RH) rotary control mounted on the center console. Air intake into the cabin is controlled by a 2 position sliding switch which is also located on the center console. For additional information, refer to: [Air Distribution and Filtering](#) (412-01 Air Distribution and Filtering, Description and Operation).

The A/C system is switched on and off using the switch located in the center console. The system will only operate when the engine is running. If A/C is requested when blower motor speed is set to 0, blower motor speed 1 will be engaged automatically.

The engine control module (ECM) monitors the engine running status and suspends A/C operation if necessary by inhibiting the compressor clutch relay.

The heated seats, heated windshield, and heated rear window systems are not part of the climate control system. For additional information, refer to:

[Seats](#) (501-10 Seating, Description and Operation),

[Glass, Frames and Mechanisms](#) (501-11 Glass, Frames and Mechanisms, Description and Operation).

## AIR INLET DUCT

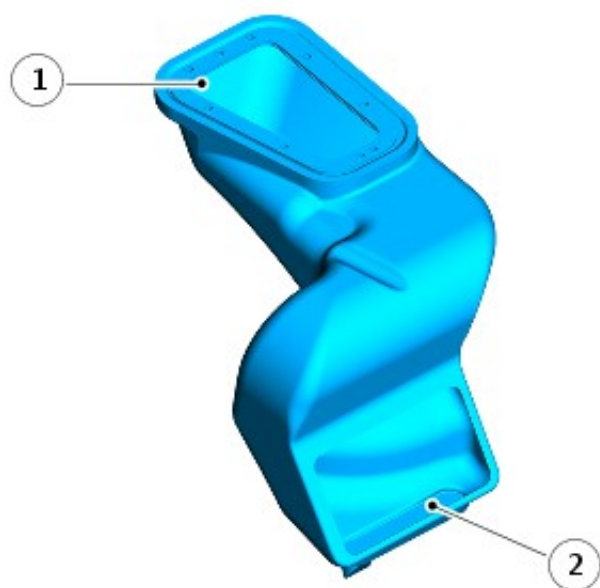

E83738

Item	Part Number	Description
1	-	Air inlet
2	-	Air outlet to blower assembly

The air inlet duct is mounted in the passenger side front fender. Air is drawn into the air inlet duct through a vent on the upper surface of the fender. The air inlet duct directs air into the air intake and blower assembly. The air intake and