



Coolant - drain and refill

26.10.01

Drain

1. Remove engine acoustic cover.
ENGINE - K SERIES KV6, REPAIRS, Cover - engine acoustic.
2. Visually check engine and cooling system for signs of coolant leaks.
WARNING: Since injury such as scalding could be caused by escaping steam or coolant, do not remove the filler cap from the coolant expansion tank while the system is hot.
3. Examine hoses for signs of cracking, distortion and security of connections.
4. Remove expansion tank filler cap.
5. Remove underbelly panel.
EXTERIOR FITTINGS, REPAIRS, Panel - underbelly.
6. Position container to collect coolant.

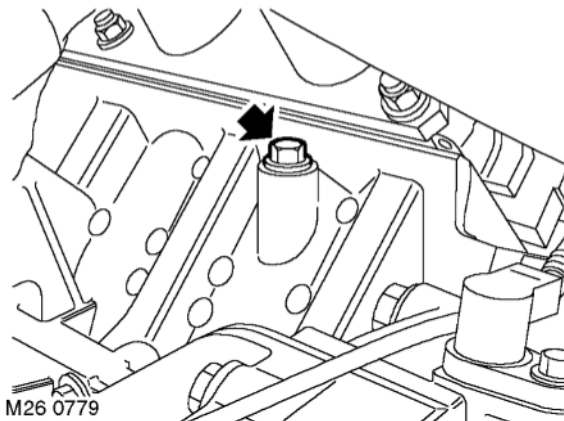

7. Remove cylinder block drain plug.

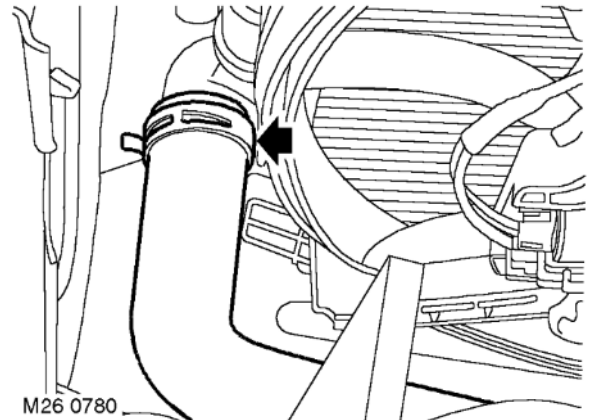

8. Release clip and remove bottom hose from radiator.
9. Allow cooling system to drain.

Refill

1. Flush system with water under low pressure.
Do not use water under high pressure as it could damage the radiator.
2. Clean cylinder block drain plug and apply sealant, Part No. STC 50552 to first 3 threads.
3. Fit cylinder block drain plug and tighten to 20 Nm (15 lbf.ft).
4. Fit bottom hose to radiator and secure with clip.
5. Prepare coolant to required concentration.
CAPACITIES, FLUIDS, LUBRICANTS AND SEALANTS, Fluids.

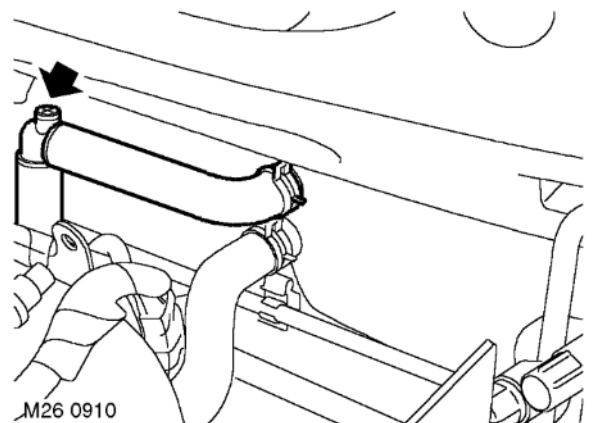

6. Remove bleed screw from heater return hose.
7. Slowly fill the system through the coolant expansion tank until a steady flow of coolant is emitted from the bleed hole.
8. Fit and close bleed screw in heater return hose.
9. Continue to fill system through the expansion tank until coolant reaches to the base of the expansion tank bleed hose.
10. Fit expansion tank filler cap.



COOLING SYSTEM - K SERIES KV6

11. Start and run engine at idle speed for 5 minutes.
CAUTION: DO NOT operate air conditioning

12. Switch off engine.
13. Squeeze bottom hose several times to remove any trapped air.
14. Start engine and run at speeds varying between idle speed and 3500 rev/min for 7 minutes.
15. Switch off engine and allow to cool.
16. Remove expansion tank filler cap and add coolant until it reaches the 'MAX' mark on the expansion tank.
17. Fit expansion tank filler cap.
18. Start and run engine until normal operating temperature is reached.

CAUTION: The bottom hose must be warm/hot, this will ensure the thermostat is fully open.

19. Ensure warm air is available at vents.
NOTE: If warm air is not available, an air-lock may be present in heater matrix. If necessary, allow engine to cool, remove expansion tank filler cap and repeat bleed operation at heater hose

20. Switch off engine and allow to cool.
21. Check for leaks and top-up coolant to 'MAX' mark on expansion tank
22. Fit underbelly panel.
 **EXTERIOR FITTINGS, REPAIRS, Panel - underbelly.**
23. Fit engine acoustic cover.
 **ENGINE - K SERIES KV6, REPAIRS, Cover - engine acoustic.**