

HEATER AND AIR CONDITIONING CONTROLS

Remove and refit

Removing

1. Disconnect the battery negative lead.
2. Remove the transmission lever surround and radio housing.
3. Remove the lower dash panel.
4. Remove the centre dash unit.
5. Disconnect the electrical leads from the thermostat, fan speed and recirculate/fresh air switches.
6. Disconnect the relay rod from the 'SCREEN-CAR' lever.
7. Disconnect the relay rod from the 'VENT' lever.
8. Disconnect the control cable from the side of the heater unit.

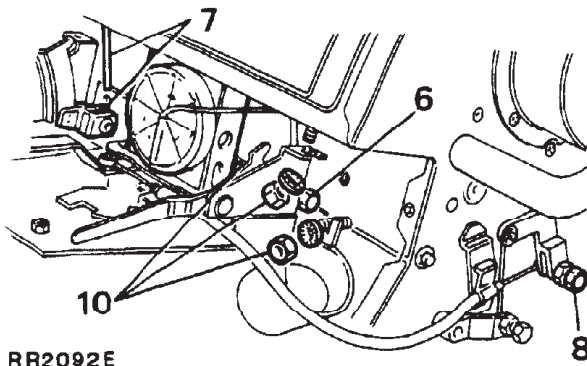

9. Remove the thermostat sensor from the fins of the evaporator.
10. Remove the four securing nuts and washers, and two screws behind the thermostat, and withdraw the heater controls assembly.
11. **Thermostat:** remove the two securing screws. Remove cable from control lever and lift thermostat over lever to remove.
12. **Fan speed switch:** remove fixing screws, and withdraw the switch.

13. **Air conditioning/fresh air/ recirculating switch:** remove fixing screws and withdraw the switch.

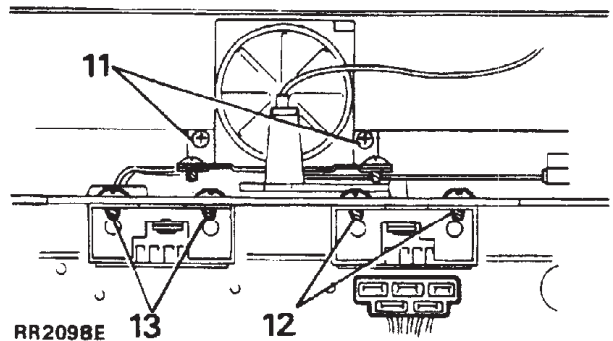

Refitting

14. Reverse instructions 5 to 13.
15. Check that the control levers give full movement to the flaps. If necessary, adjust at the relay rod or cable end fixings.
16. Reverse instructions 1 to 4.

RECIRCULATING/FRESH AIR SOLENOID SWITCH

VACUUM UNIT (recirculating/fresh air flap)

Remove and refit

1. Disconnect the battery negative lead.
2. Remove the transmission lever surround.
3. Remove the radio mounting console.
4. Remove the centre dash unit and the lower dash panel.
5. Disconnect the electrical leads to the solenoid.

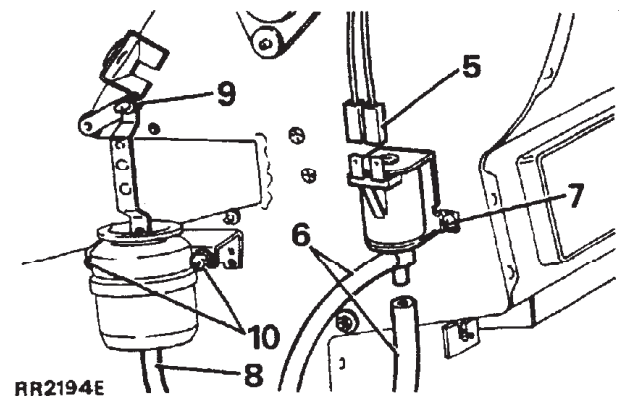

Continued

6. Disconnect the two vacuum hoses.
7. Remove the solenoid fixings and withdraw the solenoid.
8. **Vacuum unit:** remove the vacuum hose from the vacuum unit.
9. Remove the actuating rod securing clip.
10. Remove two fixing nuts and washers and withdraw the vacuum unit.

Refitting

11. Reverse the removal procedure.

VACUUM RESERVOIR (recirculating/fresh air flap)

Remove and refit

Removing

1. Disconnect the battery negative lead.
2. Remove the two vacuum hoses.
3. Loosen the reservoir fixings.
4. Withdraw the vacuum reservoir.

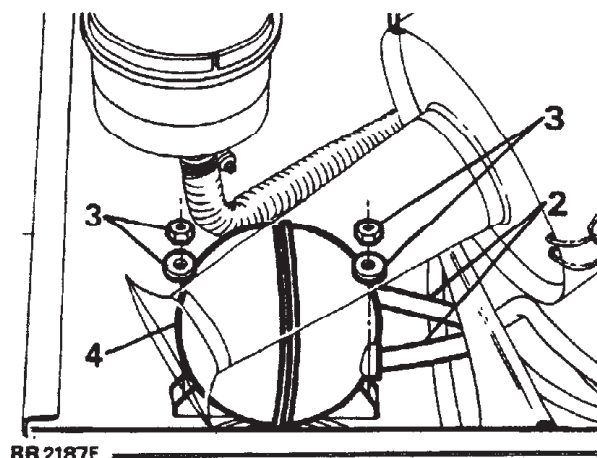

RR2187E

Refitting

5. Reverse the removal procedure. Note that the larger diameter hose, from the inlet manifold fits the inlet marked VAC on the reservoir.

HEATER UNIT

Remove and refit

Removing

1. Disconnect the battery negative lead.
2. Drain the cooling system.
3. Disconnect the water inlet hose from the heater.
4. Disconnect the water outlet hose from the heater.
5. Working inside the vehicle withdraw the lower dash and remove the screws securing the lower edge of the centre console.
6. Remove the six screws securing the lower edge of the louvre panel to the console and evaporator case.

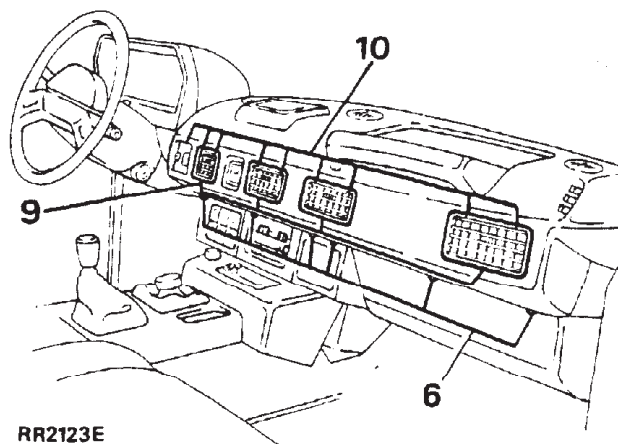

RR2123E

7. Remove the heater control panel and knobs from the centre console.
8. Remove the centre console.
9. Carefully pry out the four air vents.
10. Remove the screws securing the evaporator plenum and louvre panel to the dash top panel.
11. Withdraw the thermostat sensor from the fins of the evaporator, and pull the sensor pipe clear of the evaporator assembly.
12. Disconnect the electrical connectors at the rear of exterior driving mirror control switches and clock, and withdraw panel clear of the dash.
13. Remove the screws securing the lower right mounting bracket.

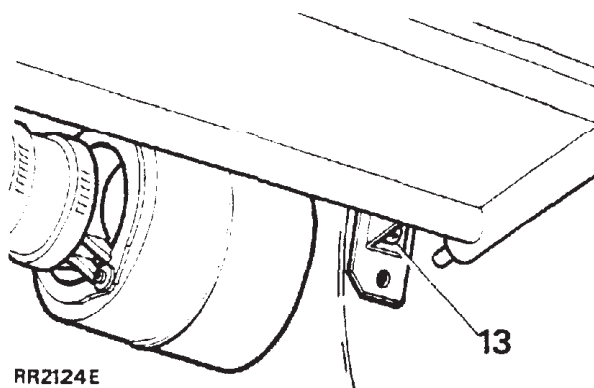

14. Support the evaporator case and remove the two nuts securing the case and reinforcing strip to the upper mounting bracket.
15. Remove the cover bracket and carefully lower the evaporator assembly to the floor of the vehicle.
16. Disconnect the six hoses from the heater unit.

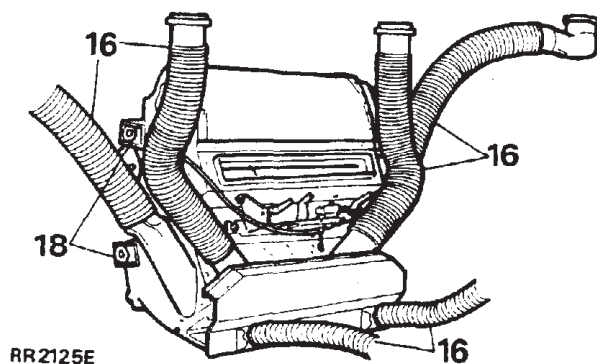

17. Disconnect the electrical leads from the heater unit at the multiplug.
18. Remove the four heater mounting bolts.
19. Remove the heater unit.

Refitting

20. Check that the seal for the fresh air intake is in place on the back of the heater unit.
21. Check that the seal for the heater core is in place on the hoses.
22. Reverse 1 to 19, ensuring that all openings are adequately sealed against the ingress of dust and moisture.

NOTE: Refer to Air Conditioning Section 82 for full instructions regarding evaporator assembly removal.

HEATER FAN MOTOR

Remove and refit

Removing

1. Remove the heater unit.
2. Disconnect the multiplug and remove the red and black leads from the multiplug.
3. Disconnect the air cooling hose.

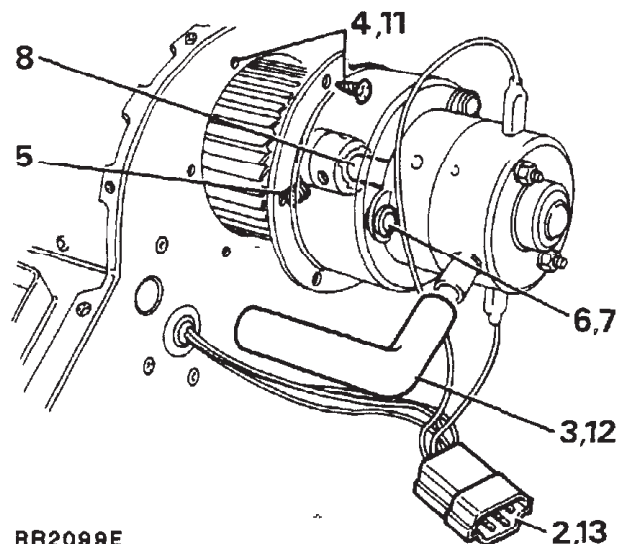

4. Remove five screws and withdraw the fan and motor assembly.
5. Loosen two set screws securing the fan to the motor shaft and remove the fan.
6. Drill out three pop rivets and remove the fan motor.

Refitting

7. Locate the fan motor and secure using suitable pop rivets.
8. Engage the fan motor shaft into the boss on the fan and secure the set screws.
9. Locate the fan motor in position, engaging the fan shaft into the bearing.
10. Hold the fan motor firmly in position and check that the fan rotates freely. If necessary, adjust the position of the fan on the motor shaft.

Continued

11. Align the air cooling hose connection and refit the five screws securing the fan motor assembly.
12. Connect the air cooling hose.
13. Reconnect the electrical leads.
14. Refit the heater unit.

FAN MOTOR RESISTANCE UNIT

Remove and refit

Removing

1. Remove the heater unit.
2. Disconnect the electrical leads at the multiplug.
3. Disconnect the air cooling hose.
4. Remove the fan motor and fan assembly.
5. Remove the electrical leads from the multiplug.
6. Drill out the two pop rivets securing the resistance unit.
7. Withdraw the resistance unit complete with leads.

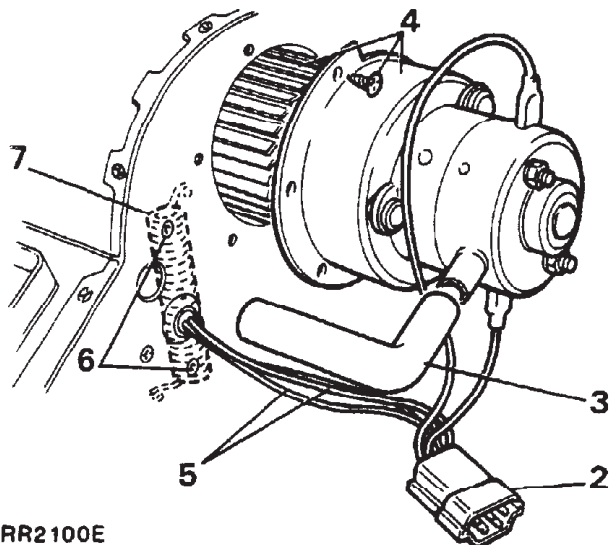

RR2100E

Refitting

8. Reverse 1 to 7.

HEATER CORE

Remove and refit

Removing

1. Remove the heater unit.

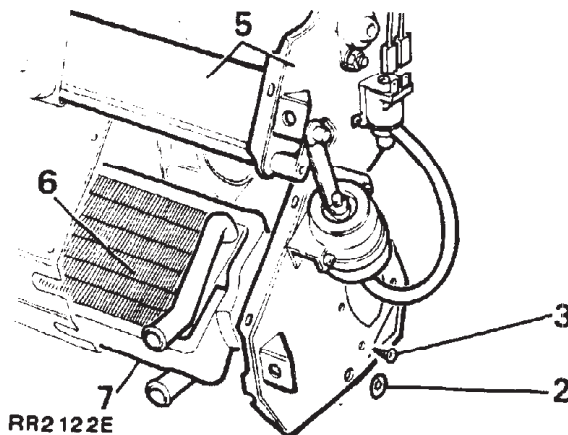

RR2122E

2. Remove the fixings from the cam bracket for the fresh air flap, and move the cam and bracket assembly aside.
3. Remove the lock-washers from the four flap shafts.
4. Remove all the drive screws from the left hand side cover.
5. Withdraw the left hand side cover complete with the fresh air flap.
6. Withdraw the heater core complete with seals.
7. Withdraw the seals from the heater core.

Refitting

8. Apply Bostik sealing compound around the flange of the left hand side cover.
9. Reverse 1 to 7.