

Front Suspension - Front Wheel Bearing and Wheel Hub

Removal and Installation

Removal

1. Raise front of vehicle.
2.  **WARNING:** Support on safety stands.
Remove front road wheel.
3. Pull back front brake caliper jump hose shield and clamp brake hose.
4. Position container collect brake fluid.
5. Loosen brake pipe to jump hose union and disconnect.

 **CAUTION:** Use 2 spanners when loosening or tightening unions.

6. Remove 2 bolts securing brake caliper to hub.
7. Remove brake caliper.
8. Remove dust cap.
9. Remove circlip and shim(s) from drive shaft.
10. Remove and discard 5 bolts securing driving member to hub.
11. Remove driving member and discard gasket.
12. Knock back staking and using a suitable socket, remove and discard hub nut.
13. Remove washer from hub.
14. Remove hub and brake disc assembly complete with bearings.

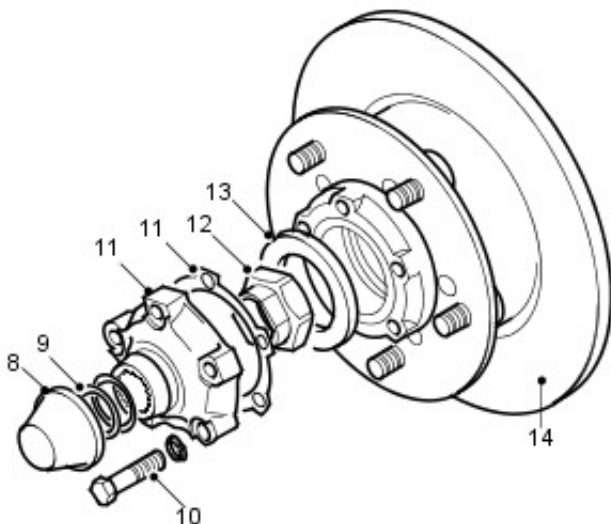

M600644A

15. Remove outer bearing and spacer from hub.
16. Remove grease seal and inner bearing from hub.
17. Remove inner and outer bearing tracks from hub.