

# Driveshaft - Driveshaft

Description and Operation

## Description

The front and rear drive shafts have non-constant velocity type universal joints, with needle roller bearings. The bearing cups are pre-packed with lubricant on assembly and a grease nipple is fitted for servicing as specified, in maintenance section.

Both shafts have ball splines to accommodate the variation in distance between the axles and transmission. The splines are pre-packed with lubricant and protected by a rubber gaiter.

**NOTE:** This joint does not require lubrication.

The front and rear driveshafts are 'phased', with the joints at each end, A and B mis-aligned as shown.

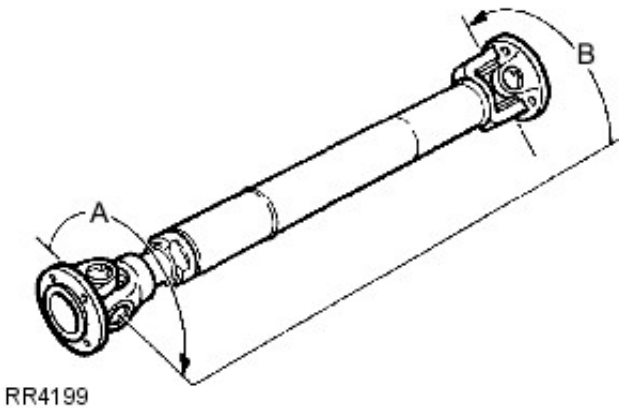

The phasing is necessary to allow for greater variation in angular changes. On reassembly it is essential the driveshafts are realigned correctly.

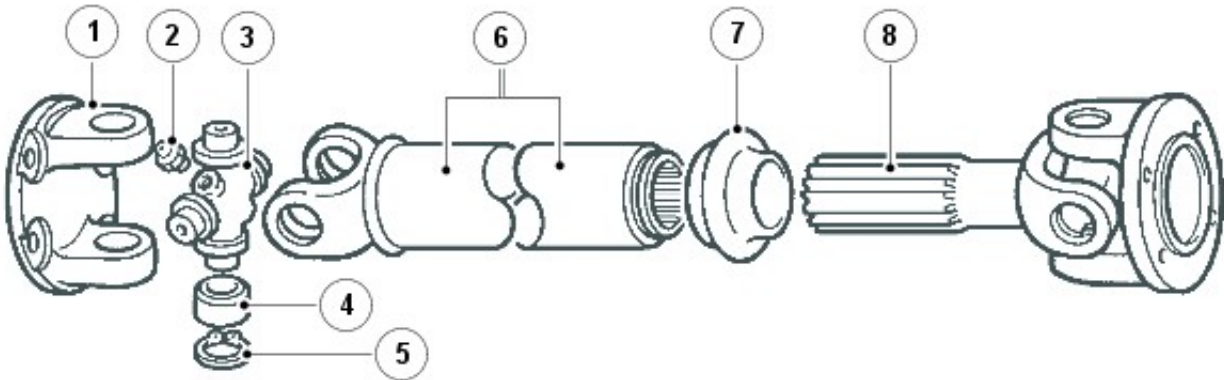

J6284

Item	Part Number	Description
1.	-	Flanged yoke
2.	-	Grease nipple
3.	-	Journal spider
4.	-	Needle roller bearing
5.	-	Circlip
6.	-	Splined shaft
7.	-	Rubber gaiter (dust cap)
8.	-	Ball spline shaft

## Vibration Harshness