

E83745

The refrigerant pressure switch is mounted monitors the high pressure side of the A/C system. The switch monitors 3 pressure ranges; high, medium and low. The pressure of refrigerant inside the system is provided to the ECM, which controls operation of the A/C compressor accordingly.

The pressure ranges monitored by the switch are as follows:

Pressure Range	Upper Limit (bar)	Lower Limit (bar)
High	32	6
Medium	15.5	12.5
Low	2.3	2

If the pressure in the system falls below 2 bar, or rises above 32 bar, the ECM will suspend A/C compressor operation by de-energizing the main relay, which subsequently de-energizes the A/C compressor clutch relay.

## AIR CONDITIONING THERMOSTATIC SWITCH

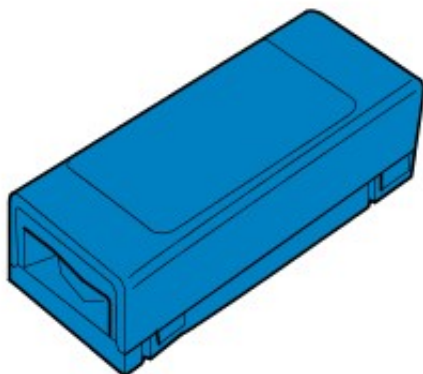

E83746

The thermostatic switch is mounted on the underside of the heater assembly and measures the temperature of the air coming off the A/C evaporator. This temperature value is fed back to the ECM which controls operation of the A/C compressor accordingly.

The ECM will suspend A/C compressor operation if the temperature of the air coming off the evaporator drops to 1°C (34 °F). This prevents the evaporator from freezing. The ECM will re-instate A/C compressor operation when the temperature of the air coming off the evaporator rises to 3.5°C (38°F).

## CONTROL DIAGRAM

NOTE: **A** = Hardwired