

Engine Emission Control - ID4 2.2L Diesel - Engine Emission Control

Description and Operation

COMPONENT LOCATION - EXHAUST GAS RECIRCULATION

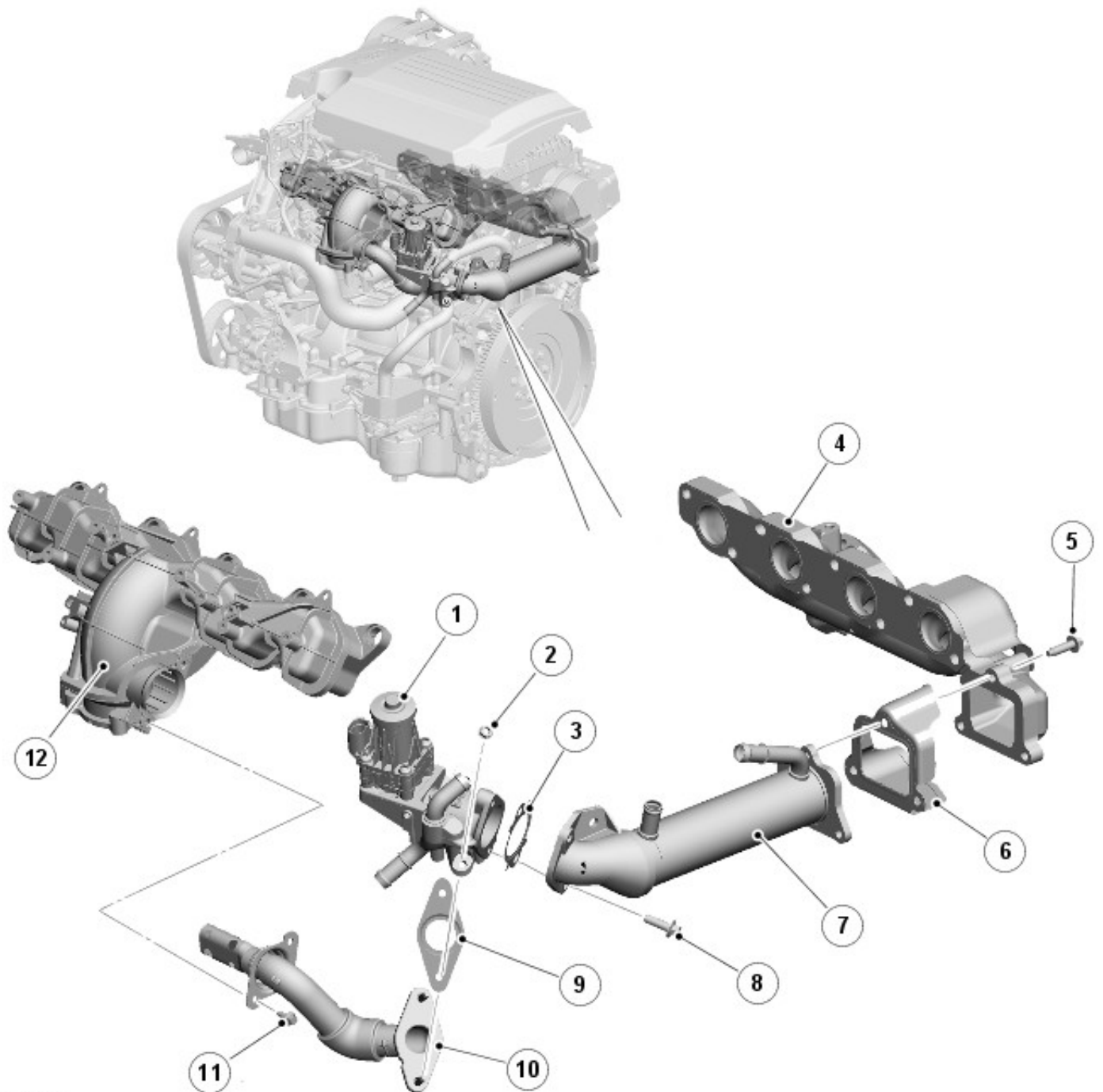

E138721

| Item | Part Number | Description |
|------|-------------|---------------------------------------|
| 1 | - | exhaust gas recirculation (EGR) valve |
| 2 | - | Nut (2 off) |
| 3 | - | Gasket |
| 4 | - | Exhaust manifold |
| 5 | - | Bolt (3 off) |
| 6 | - | Gasket |
| 7 | - | EGR cooler |
| 8 | - | Bolt (2 off) |
| 9 | - | Gasket |
| 10 | - | EGR outlet tube |