

HOME

DONAT

BOSCH

ZEXEL

DOOWON

DELPHI

VDO

CARSERVICE

SHOP

English

Русский

Germany

France

Portugal

Spain

Italian

SPONSORED SEARCHES

bosch injection pump parts

bosch diesel catalog

bosch diesel fuel pump repair

bosch repair

vp44 injection pump control module

460 long tractor injection pump

O 460 414 069, Fuel distributor injection pump BOSCH VE series,

0460414069

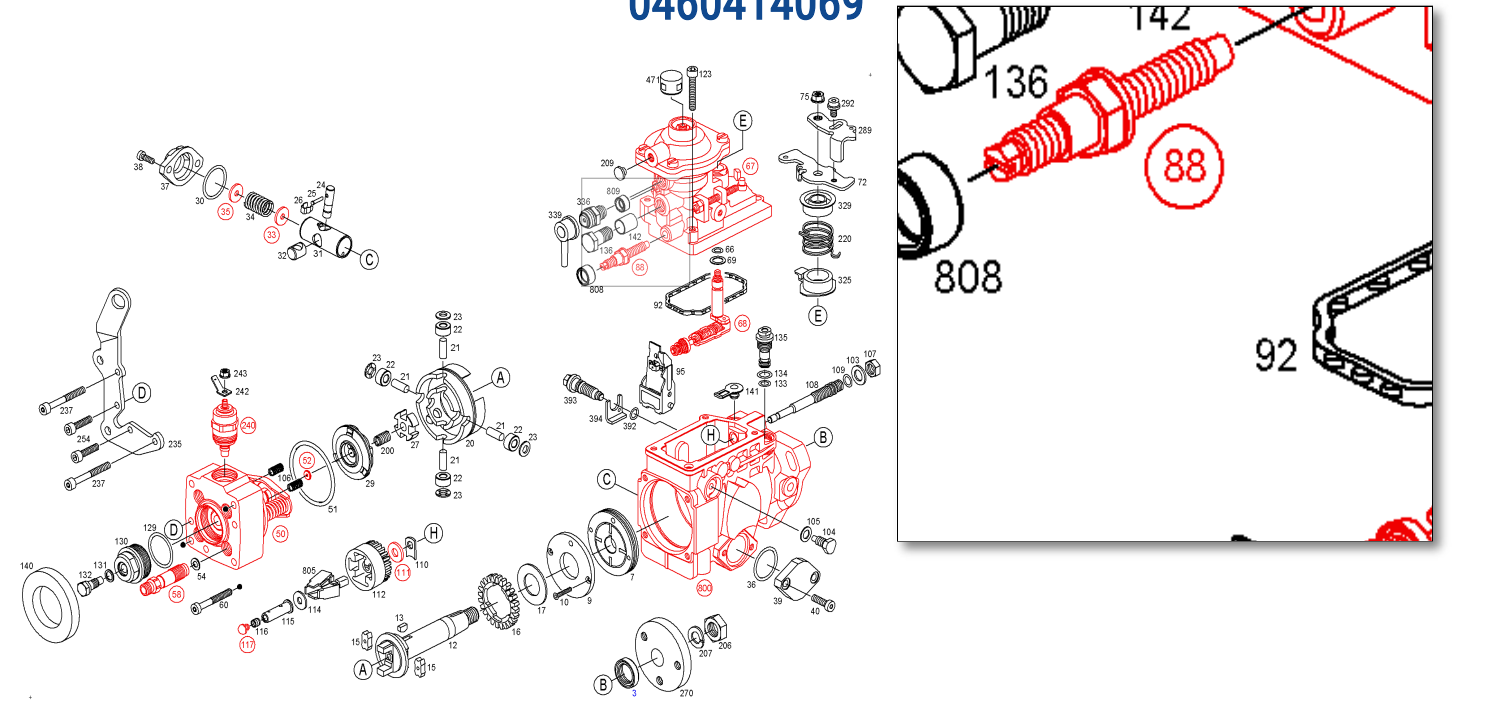

All type's appliance repairs

Get Fast & Reliable Appliance Repair from a Professional. Contact Us Today.

AA Services LTD

OPEN

REPLACING PARTS:

ORDER NUMBER	DESIGNATION	CODE	POSITION	QUANTITY
2 460 283 001	SHAFT SEALING RING	2460283001	3	1
1 467 030 308	SUPPLY PUMP	1467030308	7	1
<a href="#">1 460 134 317</a>	SUPPORT RING	1460134317	9	1
1 463 429 300	TORX FLAT-HEAD SCREW	1463429300	10	2
1 466 100 405	DRIVE SHAFT	1466100405	12	1
<a href="#">1 460 023 302</a>	WOODRUFF KEY	1460023302	13	1

1 460 056 302	BUFFER	1460056302	15	2
1 466 317 301	TOOTHED GEAR	1466317301	16	1
2 460 102 001	SLIDING DISK	2460102001	17	1
1 460 232 328	ROLLER RING	1460232328	20	1
2 463 100 002	BEARING PIN	2463100002	21	4
2 460 300 005	ROLLER	2460300005	22	4
2 460 120 013	FRICTION WASHER	2460120013	23	4
1 463 103 315	ADJUSTING PIN	1463103315	24	1
1 463 120 359	RETAINING PIN	1463120359	25	1
1 461 310 300	RETAINING BRACKET	1461310300	26	1
<a href="#">1 460 140 334</a>	CROSS DISK	1460140334	27	1
1 466 110 604	CAM PLATE	1466110604	29	1
2 460 223 001	SEAL RING	2460223001	30	1
1 463 104 469	TIMING-DEVICE PISTON	1463104469	31	1
1 463 218 312	SLIDING PIECE	1463218312	32	1
1 460 100 902	SELECTION GROUP SHIM RING	1460100902	33	2
1 464 619 817	COMPRESSION SPRING	1464619817	34	1
1 464 619 737	COMPRESSION SPRING	1464619737	34	1
1 460 100 902	SELECTION GROUP SHIM RING	1460100902	35	1
2 460 223 001	SEAL RING	2460223001	36	1
1 465 530 301	CLOSING COVER	1465530301	37	1
1 463 414 344	TORX FILLISTER SCREW	1463414344	38	2
1 461 074 312	COVER PLATE	1461074312	39	1
1 463 414 344	TORX FILLISTER SCREW	1463414344	40	2
1 468 334 851	HYDRAULIC HEAD	1468334851	50	1
2 460 210 012	O-RING	2460210012	51	1
	SELECTION GROUP SHIM		52	1
1 460 105 305	GASKET	1460105305	54	4
1 463 370 660	FITTING	1463370660	58	4
1 463 414 312	TORX FILLISTER SCREW	1463414312	60	2
1 460 210 008	O-RING	1460210008	66	1
1 467 134 299	MANIFOLD-PRESSURE COMP.	1467134299	67	1
1 463 163 126	PART LOAD GOVERNOR	1463163126	68	1
1 200 101 640	SHIM	1200101640	69	1
1 461 900 556	CONTROL LEVER	1461900556	72	1
1 463 315 310	FLANGE NUT	1463315310	75	1
	ADJUSTING SCREW		88	1
1 461 015 302	GASKET	1461015302	92	1
1 461 907 158	FULCRUM LEVER	1461907158	95	1
2 916 012 017	PLAIN WASHER, DIN 433 - 10,5-160 HV	2916012017	103	1
1 463 452 313	SLOTTED SHOULDER SCREW	1463452313	104	2
1 460 105 307	GASKET	1460105307	105	2
1 464 613 611	COMPRESSION SPRING	1464613611	106	2
1 463 300 304	HEXAGON NUT	1463300304	107	1
1 463 590 311	GOVERNOR SHAFT	1463590311	108	1

1 460 210 313	O-RING	1460210313	109	1
1 461 030 343	SHIM PLATE, 0,95 MM	1461030343	110	1
	SELECTION GROUP SUPPORTING DISK		111	1
1 466 317 319	FLYWEIGHT ASSEMBLY	1466317319	112	1
1 460 100 370	SHIM RING	1460100370	114	1
1 460 422 324	SLIDING SLEEVE	1460422324	115	1
1 460 508 309	SEALING CAP	1460508309	116	1
1 463 203 907	SELECTION GROUP PLUG	1463203907	117	1
2 910 142 207	HEX-SOCKET-HEAD CAP SCREW, ISO 4762 - M6x35-8.8	2910142207	123	4
1 460 210 349	O-RING	1460210349	129	1
1 463 461 306	SCREW PLUG	1463461306	130	1
1 460 105 306	FLAT SEAL RING	1460105306	131	1
1 463 453 306	BLEEDER SCREW	1463453306	132	1
1 460 225 081	O-RING	1460225081	133	1
1 460 225 082	O-RING	1460225082	134	1
1 460 362 419	CONTROL VALVE	1460362419	135	1
1 463 456 344	HOLLOW BOLT	1463456344	136	1
1 460 591 315	PROTECTIVE CAP	1460591315	140	1
2 410 508 006	PROTECTIVE CAP	2410508006	141	1
1 410 407 004	PROTECTION SLEEVE	1410407004	142	1
2 464 633 002	COMPRESSION SPRING	2464633002	200	1
2 915 021 004	HEXAGON NUT, DIN 934 - M14x1,5-8-A	2915021004	206	1
2 916 699 137	SPRING LOCK WASHER, DIN 128 - A14-FSt	2916699137	207	1
1 900 508 202	PROTECTIVE CAP	1900508202	209	1
1 464 651 461	COILED SPRING	1464651461	220	1
1 461 021 714	SUPPORT PLATE	1461021714	235	1
1 463 414 305	TORX FILLISTER SCREW	1463414305	237	2
0 330 001 041	PUSHING ELECTROMAGNET	0330001041	240	1
1 464 477 302	BLADE TERMINAL	1464477302	242	1
1 463 314 306	FLANGE NUT	1463314306	243	1
2 910 142 203	HEX-SOCKET-HEAD CAP SCREW, ISO 4762 - M6x25-8.8	2910142203	254	2
1 466 434 322	COUPLING HALF	1466434322	270	1
1 461 900 503	CONTROL LEVER	1461900503	289	1
1 463 433 310	WASHER-AND-SCREW ASSEMBLY	1463433310	292	1
1 460 522 328	SPRING SEAT	1460522328	325	1
1 460 522 304	SPRING SEAT	1460522304	329	1
1 463 386 301	VENT FITTING	1463386301	336	1
1 460 558 303	PROTECTIVE CAP	1460558303	339	1
1 460 210 322	O-RING	1460210322	392	1
1 463 414 306	LOCKING SCREW	1463414306	393	1
1 461 331 325	INTERMEDIATE PLATE	1461331325	394	1
1 460 505 308	CLOSURE CAP	1460505308	471	1
1 465 130 704	ASSEMBLY OF SERVICE PARTS PUMP HOUSING	1465130704	800	1
1 467 010 054	PARTS SET FLYWEIGHT	1467010054	805	1
1 460 591 313	SEALING CAP, RED	1460591313	808	1
2 420 580 005	SEALING CAP, RED	2420580005	809	1

APPLICATION:

TYPE	MANUFACTURER'S MODEL	LITRES	kW	YEAR OF MANUFACTURE	ENGINE №

COMPARISONS:

MAKE	EXTERNAL NUMBER

COMMENTS:

Facebook

В Контакте

Facebook

0 Comments

Sort byOldest





Add a comment...

Facebook Comments Plugin

 **ТНВД VE, VP, VR, PE...**

Отправка в любой регион

511 members



Follow on VK

***Support  
the project.***

***You do not have to,  
you just could.***

