

Description	Nm	lb-ft
Brake caliper bleed screw	14	10
Brake hose union	32	24
Brake disc retaining bolt	16	12
* Brake caliper anchor plate to hub bolts:		
Stage 1	15	11
Stage 2	Further 60°	Further 60°
Brake caliper housing to anchor plate bolts	35	26

**\* New bolts must be installed**

Published: 11-May-2011

## Rear Disc Brake - Rear Disc Brake

Description and Operation

### COMPONENT LOCATION

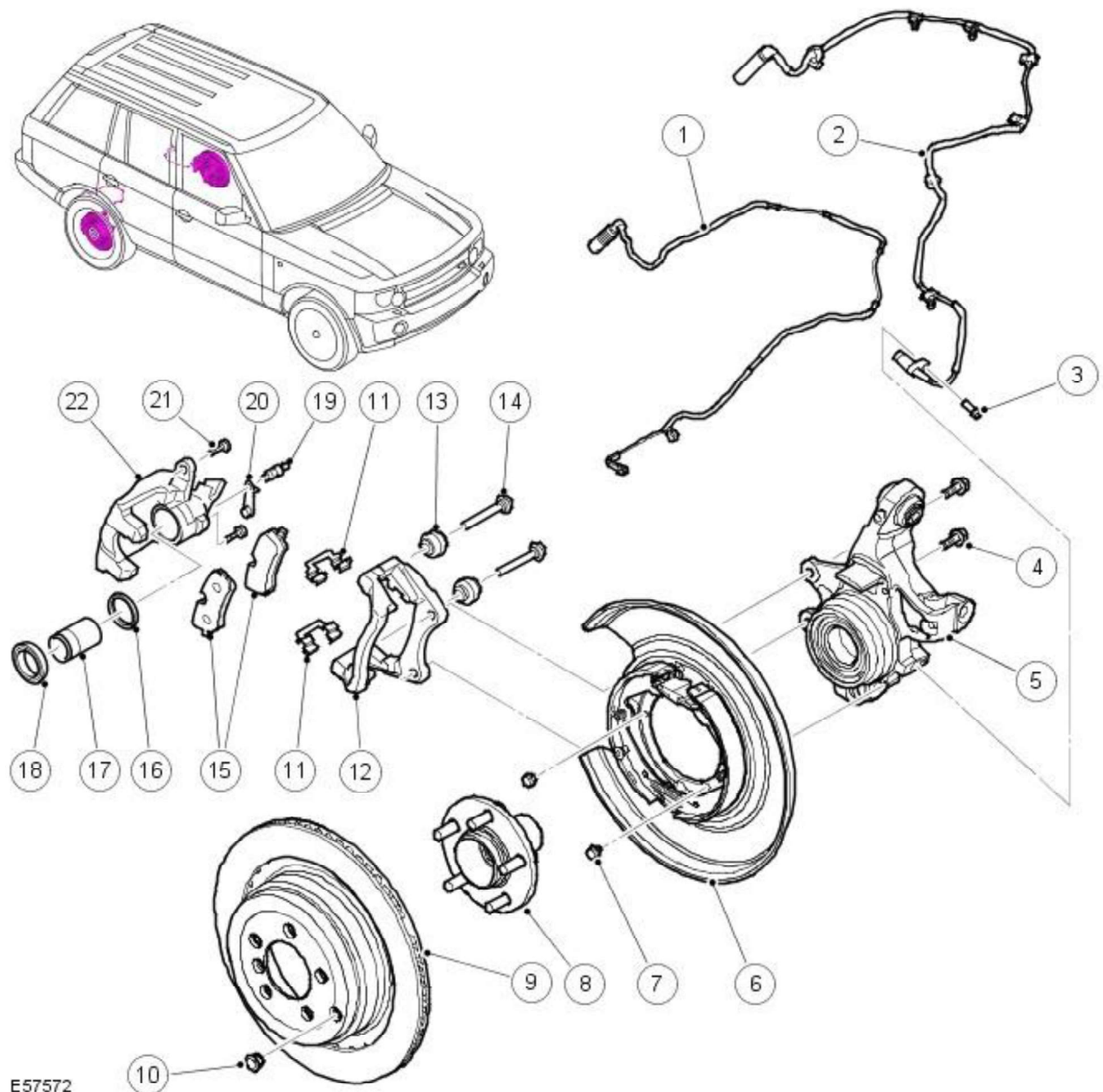

E57572