

Engine Emission Control - ID4 2.2L Diesel - Engine Emission Control

Description and Operation

COMPONENT LOCATION - EXHAUST GAS RECIRCULATION

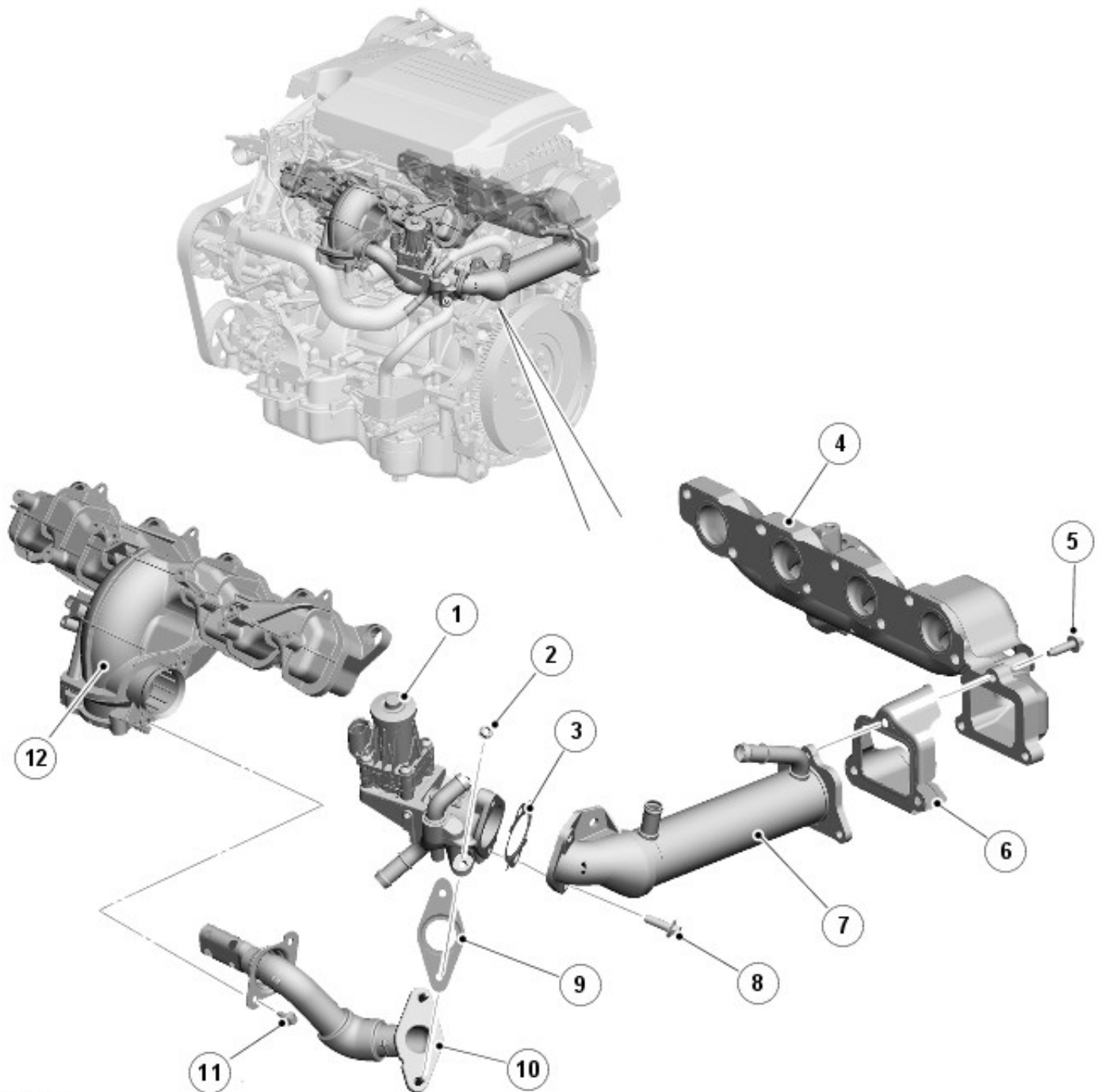

E138721

Item	Part Number	Description
1	-	exhaust gas recirculation (EGR) valve
2	-	Nut (2 off)
3	-	Gasket
4	-	Exhaust manifold
5	-	Bolt (3 off)
6	-	Gasket
7	-	EGR cooler
8	-	Bolt (2 off)
9	-	Gasket
10	-	EGR outlet tube