

32. Remove bolt and 2 nuts securing clamps to oil cooler pipes and remove clamps.

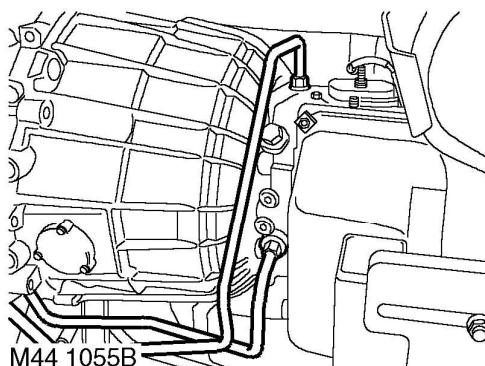

33. Loosen gearbox oil cooler pipe unions, release pipes from gearbox and discard 'O' rings.

CAUTION: Always fit plugs to open connections to prevent contamination.

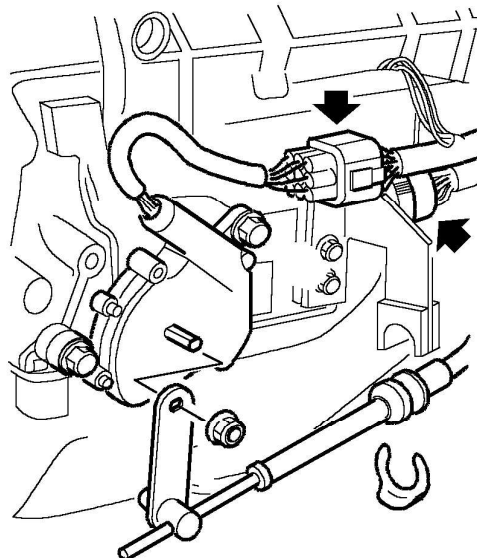

34. Remove 'C' clip securing selector cable to gearbox bracket.
35. Remove nut securing selector lever to inhibitor switch and release lever.
36. Disconnect multiplug from inhibitor switch.
37. Loosen gearbox multi plug locking ring and disconnect plug.

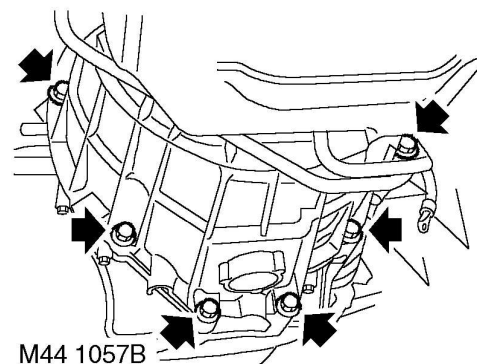

38. Remove 6 remaining gearbox housing bolts.
39. With assistance remove automatic gearbox from engine.



40. Fit suitable strap to retain torque converter.

Refit

1. Clean gearbox to engine mating faces.
2. Remove torque converter retaining strap.
3. With assistance position gearbox to engine.

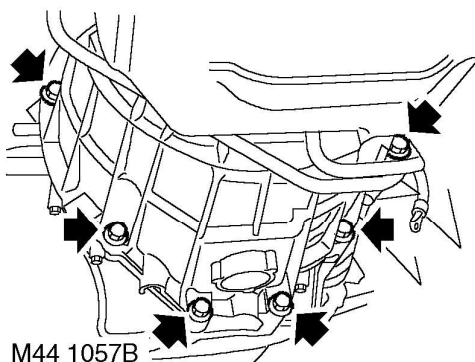

4. Fit but do not tighten six bolts securing gearbox housing to engine.
5. Connect multiplug to gearbox and tighten locking ring.
6. Connect multiplug to inhibitor switch.
7. **If fitted:** Connect and adjust differential lock selector cable.
TRANSFER BOX - LT230SE, ADJUSTMENTS, Cable - selector - differential lock - adjust.
8. Position selector lever to inhibitor switch and tighten nut to 25 Nm (18 lbf.ft).
9. Position selector cable to gearbox and secure with 'C' clip.
10. Clean oil pipe unions and fit new 'O' rings.
11. Position and tighten pipe unions to gearbox.
12. Position and tighten oil cooler pipe clamps.
13. Position and tighten oil cooler pipe clips to engine sump and alternator bracket.
14. Position engine RH and LH rear mountings and tighten bolts to 85 Nm (63 lbf.ft) and nuts to 85 Nm (63 lbf.ft).
15. Secure gearbox breather pipes to bulkhead clip.
16. **Up to 03 Model Year - If fitted:** Connect 2 Lucars to differential lock warning lamp switch and multiplugs to high/low ratio switch and neutral sensor.
17. **03 Model Year onwards - If fitted:** Connect differential lock warning lamp switch multiplugs to main harness.
18. Position cable tie and multiplug to transfer box bracket.
19. Connect high/low ratio selector cable to selector lever and secure with clevis pin.

20. Position high/low ratio selector cable to abutment bracket and secure with 'C' clip.
21. **Models fitted with high/low shift interlock solenoid:** Position interlock solenoid harness to high/low shift cable, fit sleeve around cable and harness.
22. **Models fitted with high/low shift interlock solenoid:** Connect solenoid multiplug to main harness and secure multiplug to bracket.
23. Position handbrake backplate and tighten bolts to 75 Nm (55 lbf.ft).
24. Fit hand brake drum and tighten screw.
25. Remove bolts securing tool **LRT-99-008A** to gearbox.
26. Rotate engine to align torque converter, fit new bolts and tighten to 50 Nm (37 lbf.ft).
27. Fit rear propeller shaft.
PROPELLER SHAFTS, REPAIRS, Propeller shaft - rear.
28. Fit front propeller shaft.
PROPELLER SHAFTS, REPAIRS, Propeller shaft - front.
29. Fill transfer gearbox with oil.
MAINTENANCE, PROCEDURES, Transfer box.
30. Fill automatic gearbox with oil.
MAINTENANCE, PROCEDURES, Automatic gearbox.
31. Position intermediate silencer and secure to mounting rubbers.
32. Clean silencer and tail pipe mating faces.
33. Position new gasket to tail pipe and tighten nuts to 25 Nm (18 lbf.ft).
34. Fit exhaust front pipe.
MANIFOLDS AND EXHAUST SYSTEMS - Td5, REPAIRS, Pipe - front.
35. Fit bolt securing closing plate to gearbox housing and tighten to 7 Nm (5.2 lbf.ft).
36. Fit upper bolts securing gearbox housing to engine and tighten to 50 Nm (37 lbf.ft).
37. Fit starter motor.
CHARGING AND STARTING, REPAIRS, Starter motor - diesel.
38. Tighten remaining gearbox housing to engine bolts to 50 Nm (37 lbf.ft).
39. Connect battery earth lead.
40. Fit battery cover and secure with fixings.
41. Check and adjust selector cable.
AUTOMATIC GEARBOX - ZF4HP22 - 24, ADJUSTMENTS, Cable - selector.

Gearbox - convertor and transfer gearbox - V8

44.20.04.99

Remove

1. Release fixings and remove battery cover.
2. Disconnect battery earth lead.
3. Raise vehicle on a ramp.

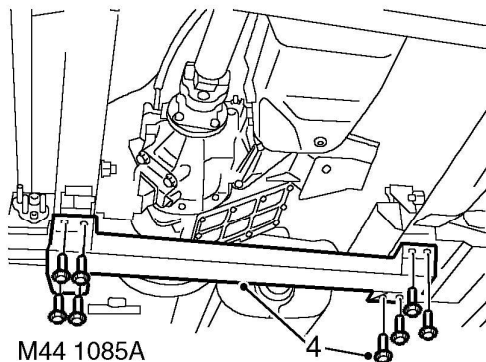

4. Remove 8 bolts securing centre cross member and remove cross member.
5. Remove exhaust front pipe.

MANIFOLDS AND EXHAUST SYSTEMS - V8, REPAIRS, Front pipe.

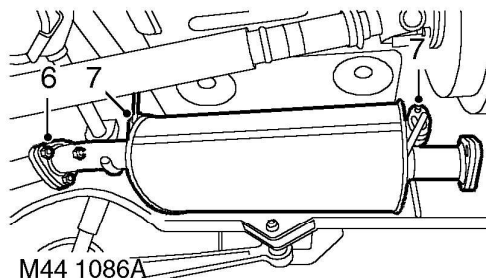

6. Remove 3 nuts securing intermediate silencer to tail pipe.
7. Release and remove silencer from rubber mountings.
8. Drain automatic gearbox oil.
9. Drain transfer gearbox oil.
10. Remove front propeller shaft

PROPELLER SHAFTS, REPAIRS, Propeller shaft - front.

11. Remove rear propeller shaft

PROPELLER SHAFTS, REPAIRS, Propeller shaft - rear.

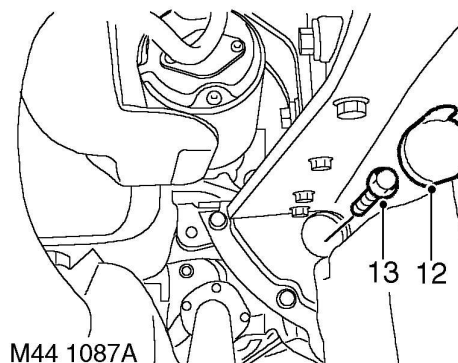

12. Remove plug from torque converter housing to access torque converter bolts.
13. Remove and discard 4 bolts securing torque converter to drive plate.

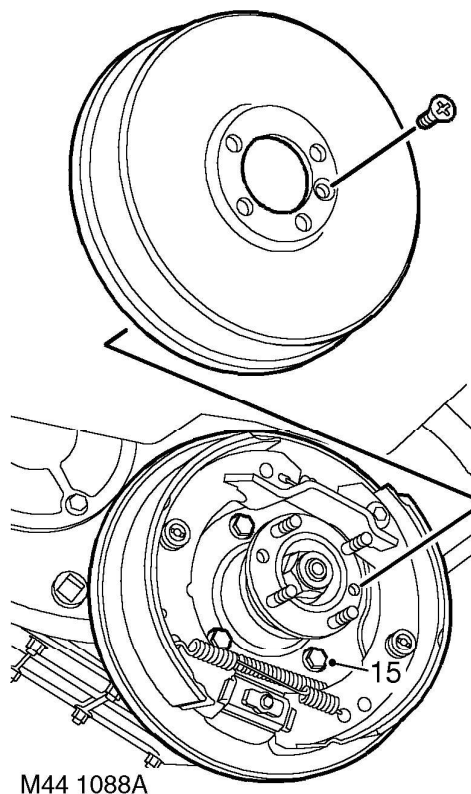

14. Remove hand brake drum retaining screw and remove brake drum.
15. Remove 4 bolts from hand brake back plate, release back plate and tie aside.



16. **Models fitted with high/low shift interlock solenoid:** Release interlock solenoid multiplug and disconnect multiplug from main harness.
17. **Models fitted with high/low shift interlock solenoid:** Remove sleeve retaining rings and remove sleeve from high/low selector cable.

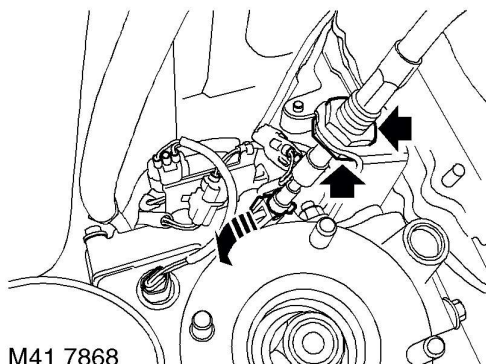

18. **If fitted** Remove and discard clevis pin securing differential lock selector cable to transfer gearbox.
19. **If fitted** Loosen locknuts securing differential lock selector cable to differential lock selector cable abutment bracket.
20. **If fitted** Release and remove differential lock selector cable from differential lock selector cable abutment bracket.

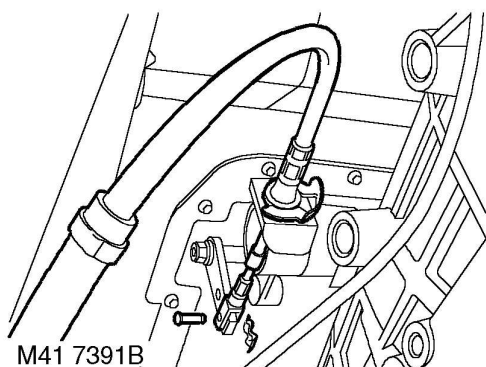

21. Remove clevis pin securing high/low ratio selector cable to selector lever, remove 'C' clip and remove outer cable from abutment bracket

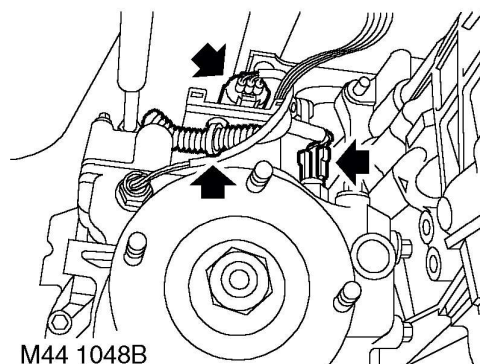

22. **Up to 03 Model Year - If fitted:** Disconnect 2 Lucars from differential lock switch and multiplugs from high/low ratio switch and neutral sensor.

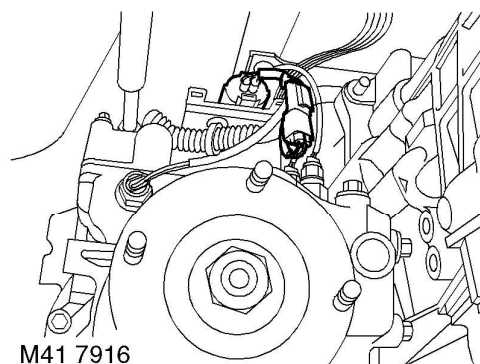

23. **03 Model Year onwards - If fitted:** Release and disconnect both differential lock warning lamp switch multiplugs from main harness.
24. Release transfer and automatic gearbox breather pipes from clip at rear of cylinder block.

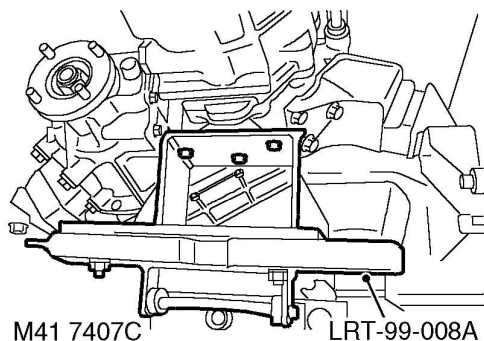

25. Position gearbox support jack and secure tool **LRT-99-008A** to support plate on jack.
26. Position a second support jack under engine using a block between engine sump and jack to prevent damage to sump.

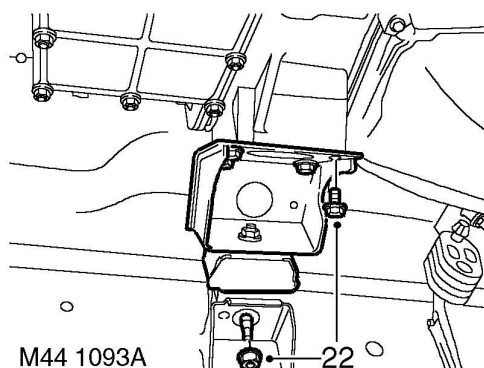

27. Remove 4 bolts and nut, remove engine LH rear mounting.

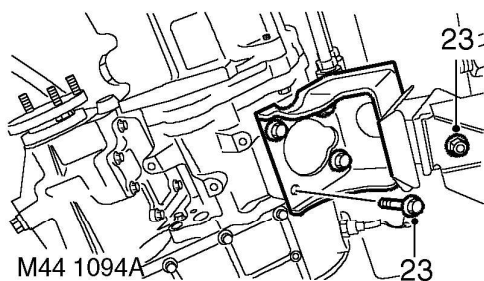

28. Remove 4 bolts and nut, remove engine RH rear mounting.

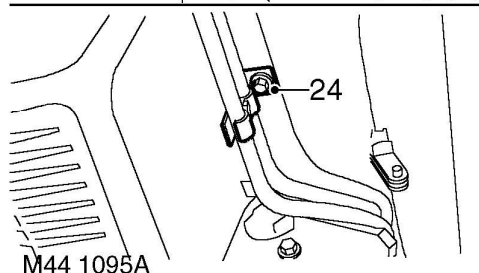
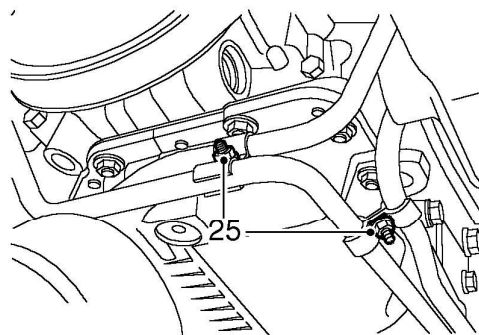

29. Remove bolt securing gearbox oil cooler pipe clips to engine.
30. Remove bolt and 2 nuts securing clamps to oil cooler pipes and remove clamps.

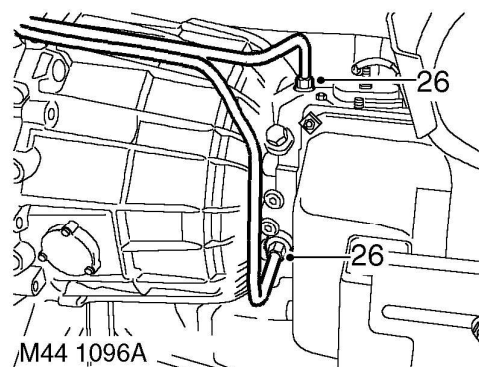

31. Loosen gearbox oil cooler pipe unions, release pipes from gearbox and discard 'O' rings.

CAUTION: Always fit plugs to open connections to prevent contamination.

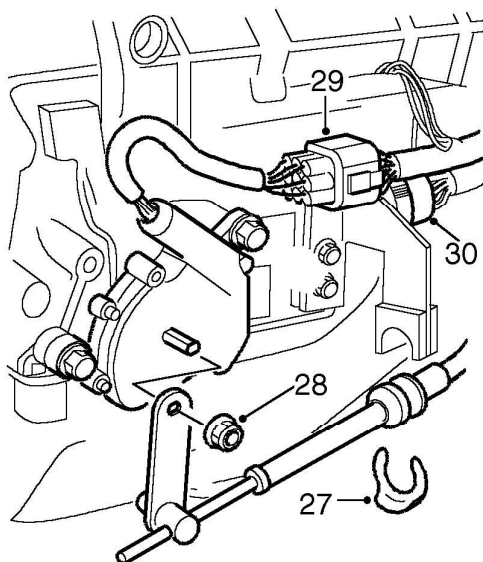

M44 1097A

32. Remove 'C' clip securing selector cable to gearbox bracket.
33. Remove nut securing selector lever to inhibitor switch and release lever.
34. Disconnect multiplug from inhibitor switch.
35. Loosen gearbox multiplug locking ring and disconnect plug.

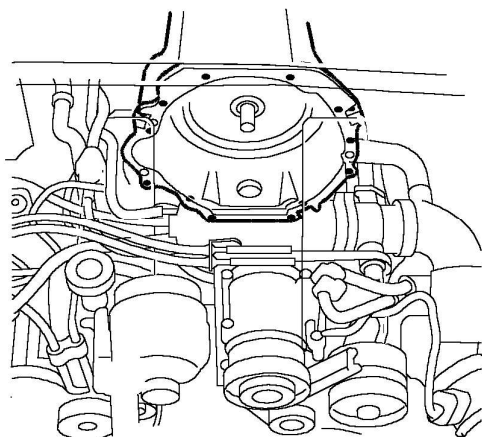

M44 1098

36. Lower gearbox sufficiently to access bell housing bolts, take care not to trap any pipes or cables when lowering gearbox.
37. Remove 14 bolts securing gearbox to engine.
38. With assistance remove gearbox from engine.

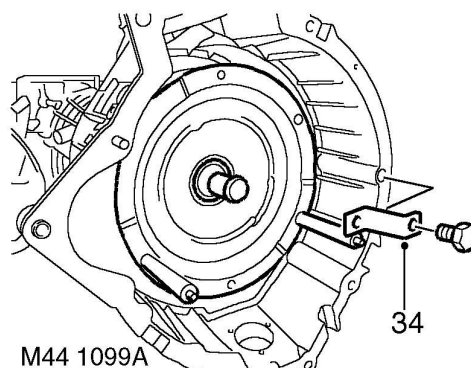

M44 1099A







39. Fit suitable strap to retain torque converter.

Refit

1. Clean gearbox to engine mating faces.
2. Remove torque converter retaining strap.
3. With assistance position gearbox to engine.
4. Fit gearbox bell housing bolts and tighten to 46 Nm (34 lbf.ft)..
5. Connect multiplug to gearbox and tighten locking ring.
6. Connect inhibitor switch multiplug.
7. **If fitted:** Connect and adjust differential lock selector cable.

TRANSFER BOX - LT230SE, ADJUSTMENTS, Cable - selector - differential lock - adjust.

8. Position selector lever to inhibitor switch and tighten nut to 25 Nm (18 lbf.ft).
9. Position selector cable to gearbox and secure with 'C' clip.
10. Clean oil pipe unions and fit new 'O' rings.
11. Position and tighten pipe unions to gearbox.
12. Position and tighten oil cooler pipe clamps.
13. Position and tighten oil cooler pipe clip to engine sump.
14. Position engine RH and LH rear mountings and tighten bolts to 85 Nm (63 lbf.ft) and nuts to 85 Nm (63 lbf.ft).
15. Secure gearbox breather pipes to bulkhead clip.
16. **Up to 03 Model Year - If fitted:** Connect 2 Lucars to differential lock warning lamp switch and multiplugs to high/low ratio switch and neutral sensor.
17. **03 Model Year onwards - If fitted:** Connect differential lock warning lamp switch multiplugs to main harness.
18. Position cable tie and multiplug to transfer gearbox bracket.
19. Connect high/low ratio selector cable to selector lever and secure with clevis pin.
20. Position high/low ratio selector cable to abutment bracket and secure with 'C' clip.

21. **Models fitted with high/low shift interlock solenoid:** Position interlock solenoid harness to high/low shift cable, fit sleeve around cable and harness, secure sleeve.
22. **Models fitted with high/low shift interlock solenoid:** Connect solenoid multiplug to main harness and secure multiplug to bracket.
23. Position hand brake back plate and tighten bolts to 75 Nm (55 lbf.ft).
24. Fit hand brake drum and tighten screw.
25. Remove bolts securing tool **LRT-99-008A** to gearbox.
26. Rotate engine to align torque converter, fit new bolts and tighten to 50 Nm (37 lbf.ft).
27. Fit access plug to torque converter housing.
28. Fit rear propeller shaft.
 **PROPELLER SHAFTS, REPAIRS, Propeller shaft - rear.**
29. Fit front propeller shaft.
 **PROPELLER SHAFTS, REPAIRS, Propeller shaft - front.**
30. Fill transfer gearbox with oil.
 **MAINTENANCE, PROCEDURES, Transfer box.**
31. Fill automatic gearbox with oil.
 **MAINTENANCE, PROCEDURES, Automatic gearbox.**
32. Position intermediate silencer and secure to mounting rubbers.
33. Clean silencer and tail pipe mating faces.
34. Position new gasket to tail pipe and tighten nuts to 40 Nm (30 lbf.ft).
35. Fit exhaust front pipe.
 **MANIFOLDS AND EXHAUST SYSTEMS - V8, REPAIRS, Front pipe.**
36. Position centre cross member, fit bolts and tighten to 26 Nm (19 lbf.ft).
37. Connect battery earth lead.
38. Fit battery cover and secure fixings.
39. Check and adjust selector cable.
 **AUTOMATIC GEARBOX - ZF4HP22 - 24, ADJUSTMENTS, Cable - selector.**